

# R6 Home

**Instruction Manual**

**Manuel De L'utilisateur**

**Инструкция Пользователя**

**Gebrauchsanleitung**

**Manual Del Uso**

**Manuale**

Thank you for choosing PUPPYOO R6 Home robot vacuum cleaner, should you have any question, please contact with us.

Si vous avez des questions sur cet produit, nous contactez par votre téléphone s'il vous plaît.

Благодарим за приобретение нашего умного робота-пылесоса R6 Home. Надеемся, что он Вам понравится, ещё раз благодарим за Ваш выбор! Если в процессе использования у Вас возникнут какие-либо вопросы, звоните по телефонам нашей сервисной горячей линии.

Wenn Sie Fragen zu diesem Produkt haben, bitte rufen Sie uns an.

Gracias por elegir el robot aspirador PUPPYOO R6 Home, si tiene alguna pregunta, póngase en contacto con nosotros por teléfono.

La ringraziamo per aver acquistato R6 Home Aspirapolvere Robot da .Se avete qualche domanda su questo prodotto durante l'utilizzo, si prega di contattarci via telefono.

 **86-10-5741 7619**

# IMPORTANT SAFETY INSTRUCTIONS

When using an electrical appliance, basic precautions should always be followed, including the following:

READ ALL INSTRUCTIONS BEFORE USING (THIS APPLIANCE), Failure to follow the warnings and instructions may result in electric shock, fire and/or serious injury.

## WARNING

To reduce the risk of fire, electric shock, or injury:

1. Do not use outdoors or on wet surfaces
2. Do not allow to be used as a toy. Close attention is necessary when used by or near children, pets or plants.
3. Use only as described in this manual. Use only manufacturer's recommended attachments
4. Do not use with damaged cord or plug. If appliance is not working as it should, has been dropped, damaged, left outdoors, or dropped into water, return it to a service center.
5. Do not pull or carry by cord, use cord as a handle, close a door on cord, or pull cord around sharp edges or corners. Do not run appliance over cord. Keep cord away from heated surfaces.
6. Do not unplug by pulling on cord. To unplug, grasp the plug, not the cord.
7. Do not handle charger, including charger plug, and charger terminals with wet hands
8. Do not put any object into openings. Do not use with any opening blocked; keep free of dust, lint, hair, and anything that may reduce air flow.
9. Keep hair, loose clothing, fingers, and all parts of body away from openings and moving parts.
10. Do not use to pick up flammable or combustible liquids, such as gasoline, or use in areas where they may be present.
11. Do not pick up anything that is burning or smoking, such as cigarettes, matches, or hot ashes.
12. Do not use without dust container.
13. Prevent unintentional starting. Ensure the switch is in the off-position before connecting to battery pack, picking up or carrying the appliance. Carrying the appliance with your finger on the switch or energizing appliance that have the switch on invites accidents.
14. Risk Of Injury. Brush May Start Unexpectedly. Remove The Brush Before Cleaning or Servicing.
15. Recharge only with the charger specified by the manufacturer. A charger that is suitable for one type of battery pack may create a risk of fire when used with another battery pack.
16. Use appliances only with specifically designated battery packs. Use of any other battery packs may create a risk of injury and fire.
17. When battery pack is not in use, keep it away from other metal objects, like paper clips, coins, keys, nails, screws or other small metal objects, that can make a connection from one terminal to another. Shorting the battery terminals together may cause burns or a fire.
18. Under abusive conditions, liquid may be ejected from the battery; avoid contact. If contact accidentally occurs, flush with water. If liquid contacts eyes, additionally seek medical help. Liquid ejected from the battery may cause irritation or burns.
19. Do not use a battery pack or appliance that is damaged or modified. Damaged or modified batteries may exhibit unpredictable behavior resulting in fire, explosion or risk of injury.

20. Do not expose a battery pack or appliance to fire or excessive temperature. Exposure to fire or temperature above 130°C may cause explosion.
21. Follow all charging instructions and do not charge the battery pack or appliance outside of the temperature range specified in the instructions. Charging improperly or at temperatures outside of the specified range may damage the battery and increase the risk of fire.
22. Have servicing performed by a qualified repair person using only identical replacement parts. This will ensure that the safety of the product is maintained.
23. Do not modify or attempt to repair the appliance or the battery pack except as indicated in the instructions for use and care.
24. Place the cords from other appliances out of the area to be cleaned.
25. Do not operate the vacuum in a room where an infant or child is sleeping.
26. Do not operate the vacuum in an area where there are lit candles or fragile objects on the floor to be cleaned.
27. Do not operate the vacuum in a room that has lit candles on furniture that the vacuum may accidentally hit or bump into.
28. Do not allow children to sit on the vacuum.
29. Do not use the vacuum on a wet surface.

## **SAVE THESE INSTRUCTIONS**

Household use only.

# FCC/IC COMPLIANCE / TM / WARRANTY

To satisfy FCC&IC RF exposure requirements, a separation distance of 20cm or more should be maintained between the antenna of this device and persons during device operation.

To ensure compliance, operations at closer than this distance is not recommended.

Les antennes installées doivent être situées de façon à ce que la population ne puisse y être exposée à une distance de moins de 20 cm. Installer les antennes de façon à ce que le personnel ne puisse approcher à 20 cm ou moins de la position centrale de l'antenne.

This device complies with Part 15 of the FCC Rules / Industry Canada licence-exempt RSS standard(s).

Operation is subject to the following two conditions: (1) this device may not cause harmful interference, and (2) this device must accept any interference received, including interference that may cause undesired operation.

Le présent appareil est conforme aux CNR d'Industrie Canada applicables aux appareils radio exempts de licence. L'exploitation est autorisée aux deux conditions suivantes :

(1) l'appareil ne doit pas produire de brouillage, et (2) l'utilisateur de l'appareil doit accepter tout brouillage radioélectrique subi, même si le brouillage est susceptible d'en compromettre le fonctionnement.

Changes or modifications not expressly approved by the party responsible for compliance could void the user's authority to operate the equipment.

This equipment has been tested and found to comply with the limits for a Class B digital device, pursuant to part 15 of the FCC Rules. These limits are designed to provide reasonable protection against harmful interference in a residential installation. This equipment generates uses and can radiate radio frequency energy and, if not installed and used in accordance with the instructions, may cause harmful interference to radio communications. However, there is no guarantee that interference will not occur in a particular installation. If this equipment does cause harmful interference to radio or television reception, which can be determined by turning the equipment off and on, the user is encouraged to try to correct the interference by one or more of the following measures:

- Reorient or relocate the receiving antenna.
- Increase the separation between the equipment and receiver.
- Connect the equipment into an outlet on a circuit different from that to which the receiver is connected.
- Consult the dealer or an experienced radio/TV technician for help.

# Contents

<b>1. Safety instruction</b>	01
1.1 Notice for use	01
1.2 Matters need attention	01
1.3 Children safety	02
1.4 Battery	03
1.5 Usage range	03
<b>2. Product</b>	04
2.1 Main body and components	04
2.2 Parts name	05
<b>3. Product assembly</b>	08
3.1 Charge station assembly	08
3.2 Install and use water tank	09
3.3 Power on	10
<b>4. Using product</b>	11
4.1 Buttons and indicators	11
4.2 How buttons works	11
4.3 How indicators works	12
4.4 Download and use APP	13
<b>5. Product maintenance</b>	23
5.1 Clean charging electrode slice	23
5.2 Clean dust container	23
5.3 Clean main brush	25
5.4 Clean side brush	26
5.5 Clean wheels	26
5.6 Clean sensors	26
<b>6. Trouble shooting</b>	27
<b>7. Parameters</b>	28

# 1. Safety instruction

## 1.1 Notice for use

Before use, please read the safety precautions below carefully:

Please read all the instructions before using this appliance.

Any operation that does not comply with this manual may result in serious personal injury or damage to the appliance itself.

## 1.2 Matters need attention

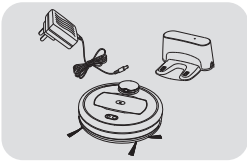

 This appliance can only work with the adaptor, battery and charge station together with the parcel which committed to this appliance, otherwise it may cause damage to the machine or electric shock or fire.

 Please do not use this appliance if the machine or accessories get broken. Please contact with our after-sales service when you meet problem.

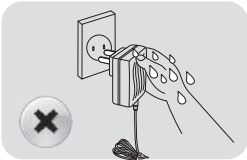

 Please remove the plug from the socket before maintenance.

 Please do not touch the plug or the appliance with wet hands, or it may lead to electric shock.

 Please contact with our customer service if the cable gets broken to avoid danger.

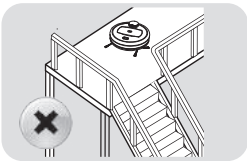

 Do not use this appliance in the absence of a fence to avoid accidental fall of the robot.

 Please don't replace non-original battery by yourself.

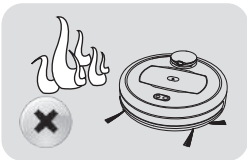

 Do not get clothes or any part of your body (hair, finger, etc.) involved in the brush or wheel of the appliance, or it may cause danger.

 Don't put the appliances close to fire, inflammable, explosive or corrosive materials.

 Please contact with our customer service to get e-edition manual if your manual gets lost.

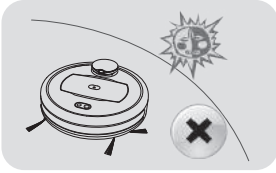

This appliance can only be used indoors.

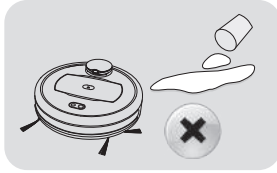

Do not vacuum water, oil or other liquid or it will cause damage to the appliance.

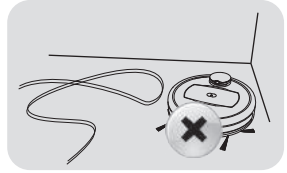

Tidy cables on the ground before using, so as not to hinder the appliance work.

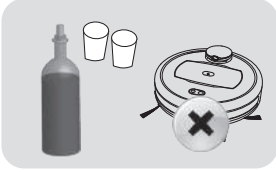

Please remove vulnerable items before using.

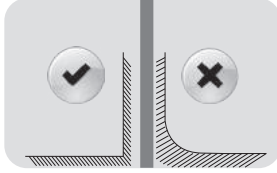

Place the charge station on the flat floor and keep it vertical with the wall. Avoid affection to the function of the appliance.

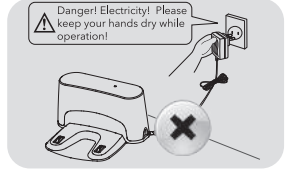

Danger! Electricity! Please keep your hands dry while operation!

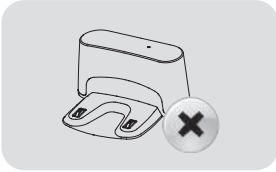

Do not remove the charge station while the appliance is working, or it may not return and recharge.

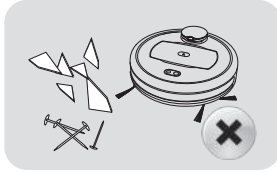

Do not vacuum sharp objects like glass sheets, iron nail etc. , to avoid damage to the appliance.

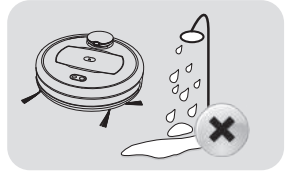

Do not use the appliance in humid or flammable, explosive, perishable environments.

## 1.3 Children safety

1) This appliance should not be operated by children under 8 years old or people who is physically or mentally disabled or lack of relevant experience and knowledge, unless under the guidance and supervision of people who could be responsible for the user's safety.

2) Prohibit children from playing bags of the appliance, or it may cause suffocation.



## 1.4 Battery



- 1) This product is limited to use the battery equipped by the manufacturer.
  - 2) Please remove the battery before dispose the appliance.
  - 3) Please contact with our after sale service if you want to replace the battery. Do not use any other charger to recharge the battery pack.
  - 4) If the battery gets leakage, do not let the liquid get into skin or clothes, clean with dry cloth immediately, and put it back to recycle bin, do not throw it away.
  - 5) Please dispose the waste battery of the appliance properly.
- Batteries contain hazardous substances that are hazardous to the environment. Please follow your local environmental regulations and place it on the required recycling sites.



## 1.5 Usage range

This appliances is suitable for the following surfaces:



Wood Floor

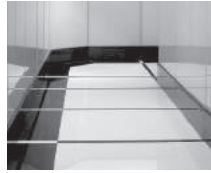

Tile

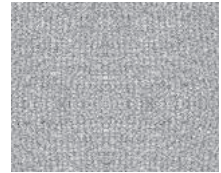

Short Hair Carpet

### Attention before first use:

Due to different living environment, if the desk or sofa bottom is lower or barely higher than the robot, the robot may get stuck, because there is a fade area of several millimeters on top of the anti-collision radar.

It is recommended to set that area as forbidden area to avoid stuck before first use, after scan the map.

"Forbidden area" setting is in the manual "4.4 Download and use APP"

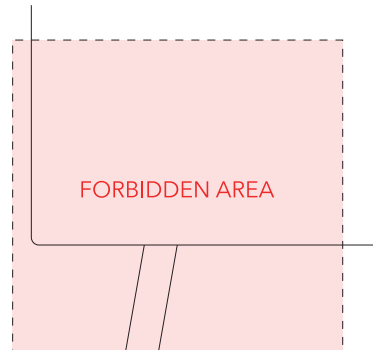
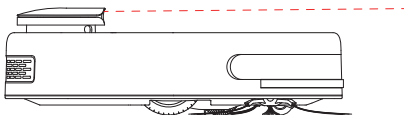

# 2. Product

## 2.1 Notice for use

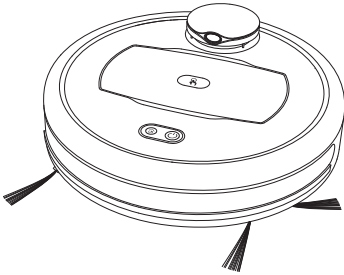

Main Unit



Charge Station



Adaptor



Cleaning Brush

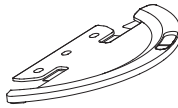

Water tank



Mop

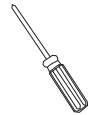

screw driver

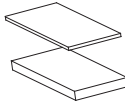

Filter Screen Pack



Side brush

## 2.2 Parts name

### Front View of the Machine

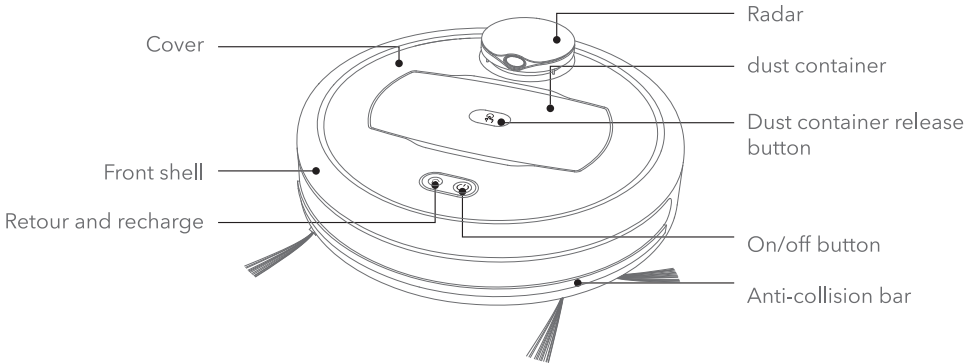

### Bottom View of the Machine

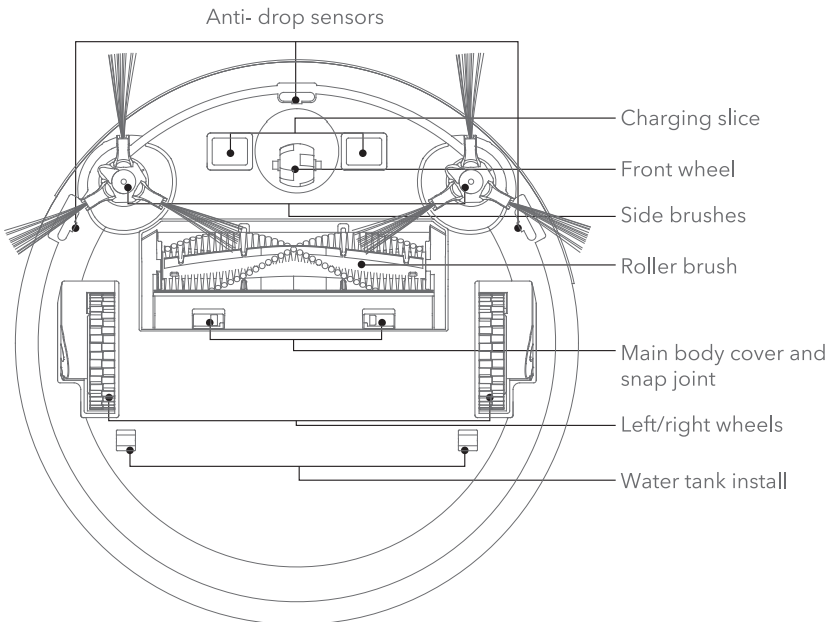

### Side view of the machine

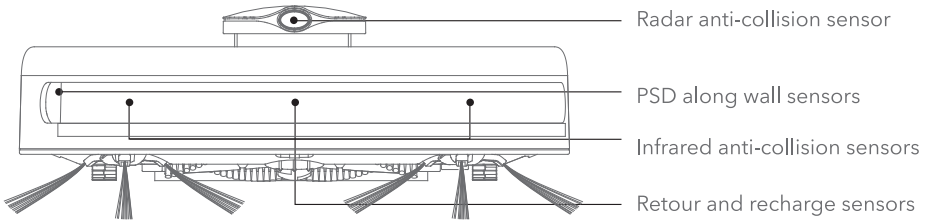

### Water tank

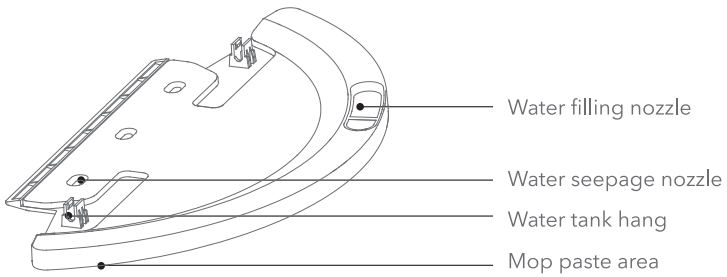

### Charge station front view

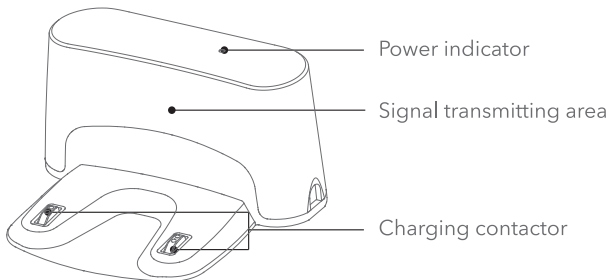

## Dust container disassemble figure

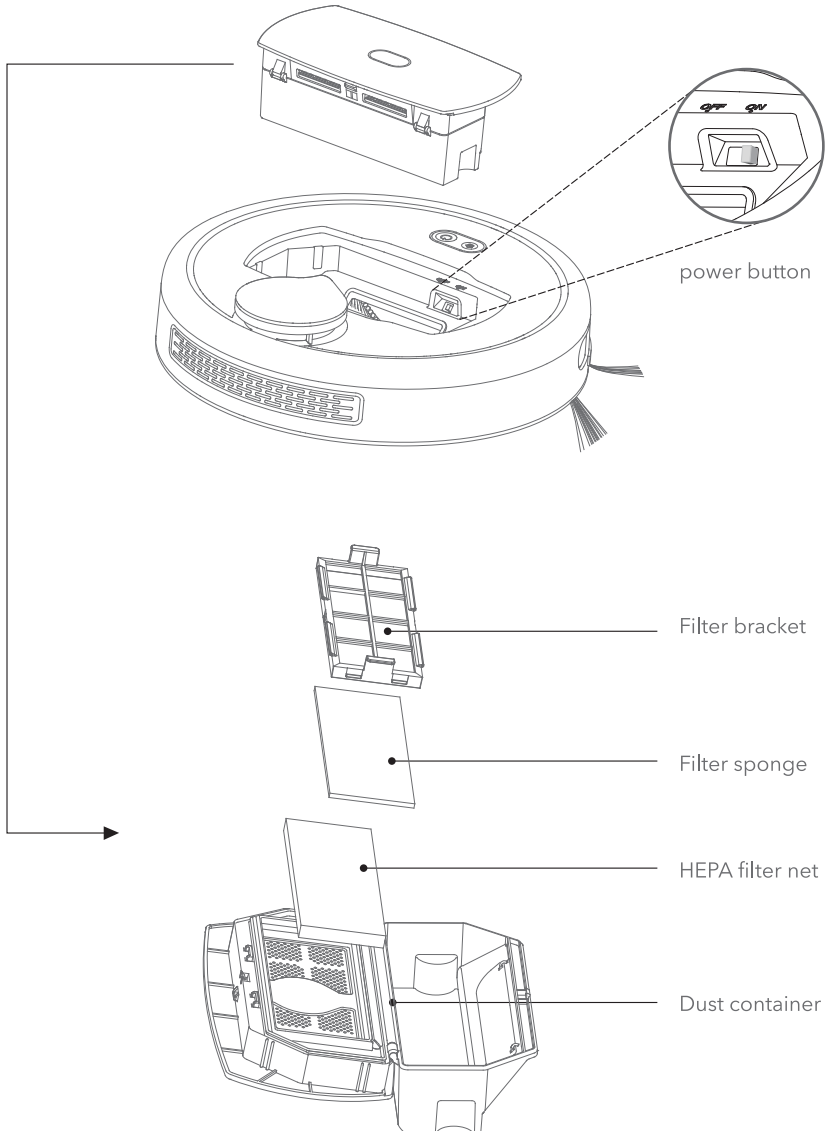

# 3. Product assembly

## 3.1 Charge station assembly

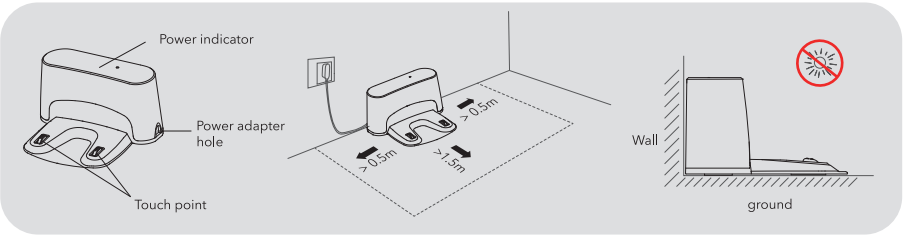

- 1) Lay the charge station on flat floor that vertical to the wall. No obstacle in a distance of 1m from left to right, and 1.5m in front of the station. Press the station to stick to the floor.
- 2) To make sure the main body works well and recharge successfully, please don't move the charge station casually or frequently, if the station is moved, main body may fail to locate and lost map information, and it will rebuild and memorize map information before work again.

**Note:** Rebuild map may lead to the lost of cleaning area and forbidden area information.  
Avoid direct sunshine.

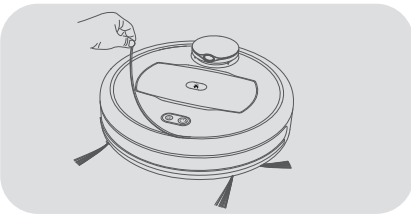

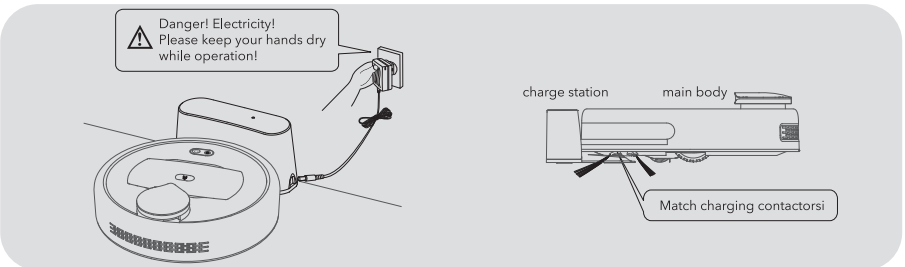

- 3) Remove the protect bar on front loop shell to make sure the robot works well.



- 4) Connect charge station and power cord, and tidy up power cord, in case it may be twined by the robot.

### 5) Charging.

Method 1: put main body on the station and match charging contactors, power indicator on the station off, starts to charge. Take this way when the main body can not turn on or retour to recharge on low power.

Method 2: press dust container release button  , take out dust container, push power button to "on", put in dust container, after the robot turns on, put it in front of charge station, in a distance of 1 meter, press retour and recharge button  , it will retour and recharge automatically.

## 3.2 Install and use water tank

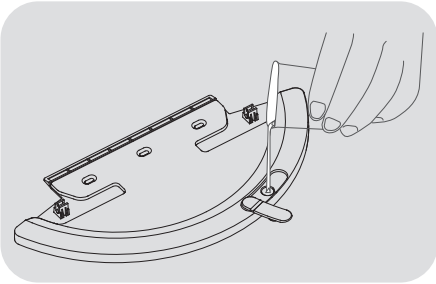

Step 1: fill in water from Water filling nozzle

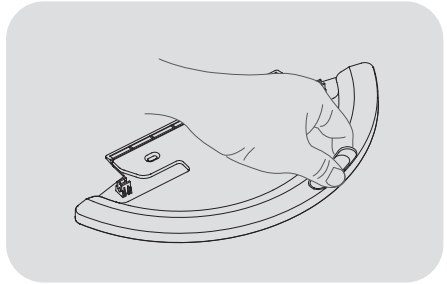

Step 2: seal the Water filling nozzle

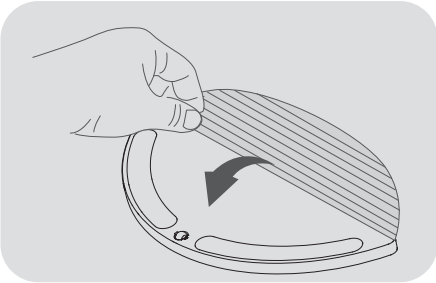

Step 3: stick the mop

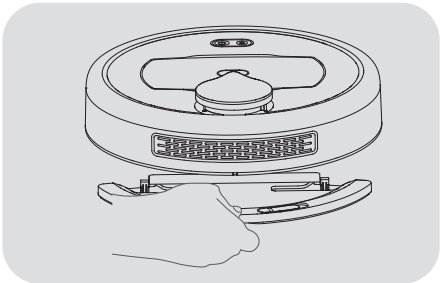

Step 4: stuck water tank to main body.

### **Note:**

Remove water tank while charging.  
Do not use water tank on blanket.

### 3.3 Power on

Place the host on the charging stand of the power adapter, press the dust box eject button in the middle of the dust box to remove the dust box, push the switch button located in the main unit to "on", put it back into the dust box, long press the "⏻" start button on the main unit for 3 seconds, and wait for about 20 seconds after the device is turned on (the voice prompt "Xiao Wang is ready"), you can operate.

#### Note:



If main body can not start after pushing power button to "on", please press on/off button ⏻ to start.

- 1) Clean: Press on/off button ⏻ after it turns on, and it will scan the map and clean, press ⏻ again to stop, and 10 minutes later, it will switch to sleep mode, press any button to wake it up.
- 2) Return and recharge, press return and recharge button 🏠 when the main body stops, it will search charge station and recharge automatically.
- 3) Deep sleep mode: Long press ⏻ for 3 seconds, red lights will flash and save data, and main body will disconnect wifi and turn to deep sleep mode after red lights off.
- 4) Wake up main body: Press ⏻ to wake up main body, blue lights will flash for 20 seconds, and purple lights on means wake up successfully.

Please refer to "4.4 Download and use APP" to download APP and Wi-Fi setting.

# 4. Using product

## 4.1 Buttons and indicators

Number	Category	Name	Location	State
1	Main body buttons	Power button	Take out dust container, the button is in the robot	Push the button to "ON" and press and hold the "⏻" start button on the main unit for 3 seconds. After about 20 seconds, the main unit will start up. Push to the "off" host to power off, and will clear unsaved maps and settings
2		Start/pause button	Main body cover	⏻ with elliptical loop light
3		Retour and recharge button	Main body cover	🏠 with elliptical loop light
4	Dust container buttons	Dust container release button	In the middle of the dust container	Press 🗑️ to release dust container
5	Indicators	Work	Around start/pause button	Blue light means normal condition, light loop: 
6		Breakdown	Around start/pause button	Red light means breakdown or low power, light loop: 
7		WIFI	Around start/pause button	Purple light means WIFI unconnected, light loop: 

## 4.2 How buttons works

Button type	operation	function description
Power button	On	Push the button to "ON" and press and hold the "⏻" start button on the main unit for 3 seconds. After about 20 seconds, the host will start up and have a voice prompt.
	Off	Push the button to "off" to cut down power, clear unsaved map and setting.
Start/pause	Press when main body pause	Start cleaning (continue with unfinished work or start auto cleaning mode)
	Press when main body works	Pause/stop: stop cleaning or recharge
	Long press for 3 seconds when main body pause	Deep sleep mode
Retour and recharge	Press when main body pause	Retour and recharge
	Press when main body works	Pause
	Long press for 3 seconds or longer	Partial cleaning, clean a 2*2 meters maching-centered square area
⏻ Start/pause + 🏠 Retour and recharge	Long press for 3 seconds when main body pause	Reset WIFI (Maching will stop if it were cleaning or retour and recharge)

## 4.3 How indicators works

Number	Condition	Indicator
1	Starting	Blue breathing indicator
2	Started	Purple indicator flash when Wi-Fi not connected, and blue indicator is on when Wi-Fi connected
3	Wi-Fi unconnected	Purple indicator is on
4	Device is binding	Purple indicator flash, then turns on
5	Reset Wi-Fi	Purple indicator flash slowly
6	Wi-Fi connected	Blue Indicator is on
7	Charging while robot is on	Breathing indicator (blue when Wi-Fi connected, purple when Wi-Fi unconnected), charging station light off
8	Fully charged while robot is on	Indicator turns on (blue when Wi-Fi connected, purple when Wi-Fi unconnected), charging station light off
9	Charging or fully charged while robot is off	Blue indicator flash slowly, charging station light off
10	Cleaning	Indicator turns on
11	Retour and recharge	Flash slowly (blue when Wi-Fi connected, purple when Wi-Fi unconnected)
12	Low power and recharge	Red indicator turns on
13	Pause	Indicator turns on
14	Sleep	Dark indicator
15	Standby	Indicator turns on
16	In trouble	Red indicator flash
17	Dust container taken out	Red indicator flash
18	Power off	Indicator turn off

## 4.4 Download and use APP

### Attention:

The document will update because of APP update or other reasons, and can only be used as a guidance, unless otherwise stated. Description, information and suggestions don't constitute any guarantee.

### Summary:

The document mainly states operation procedures and matters need attention for new users.

### APP download and using environment

Phone with Android 4.4 or IOS 8.0 and upper version system, download "Puppy Robot" APP.

Method 1: Scan QR code



Scan with Android phone



Scan with iphone

Method 2: Turn to Google Play or App Store, search "Puppy Robot" and download.

### Preparation:

#### 1.Reset WIFI

Start main body, long press  and  together for 3 seconds, purple light flash.

WIFI indicator condition

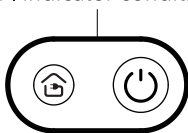

purple light flash slowly: wait for connection  
blue: Wi-Fi connected

2.Turn to phone "setting", WLAN setting, connect Wi-Fi ( same name with main body Wi-Fi in APP).

3.Find the APP on your phone and click.

# 1) Register and login

1. Register if you are a new user. Input phone number or email address, set password, click "send verification code", and input the code after you receive it, click "register".

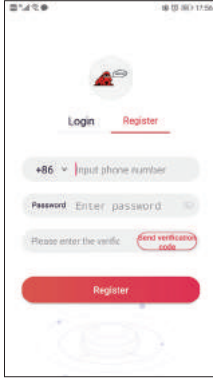

2. Input registered account with phone number or email address, input password and login.

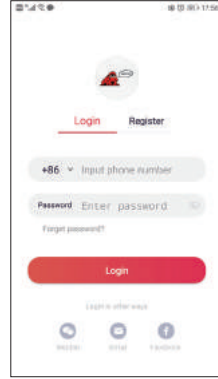

3. If you have an account but forget password, click "forget password" to get your password back.

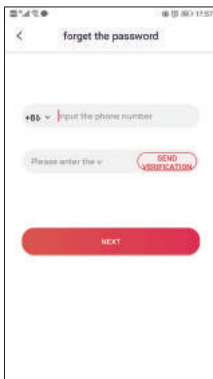

## 2) Add device

1. Click "add device" after login, add robot.

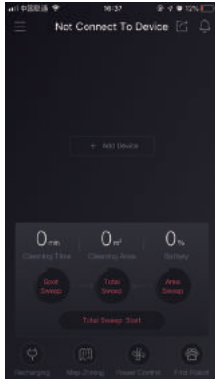

2. Follow the guidance in the APP, if the connection breaks because of bad signal, please try again.
- Turn on the power button (take out dust container first).
  - Click add device.
  - Press start and return button and hold for 3 seconds.
  - Click "next".

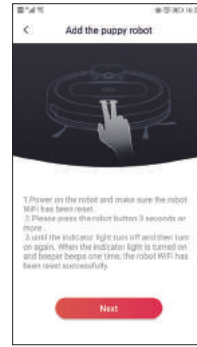

Take the following procedure with iPhone:

3. Connect home Wi-Fi, input Wi-Fi name and password, click "next".  
(Please set a password first if there is no password)

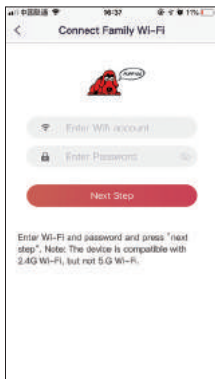

Take the following procedure with Android phone :

3. Connect robot hotspot.  
(Wi-Fi name starts with puppy)

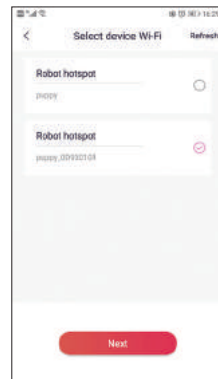

Take the following procedure with iPhone:

4. Turn to Wi-Fi setting, choose Wi-Fi name starts with "puppy".  
Back to APP, click "connect to robot".

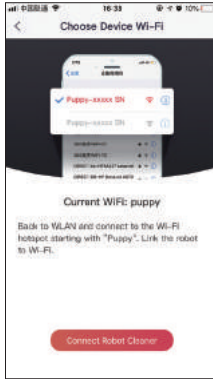

Take the following procedure with Android phone :

4. Connect home Wi-Fi, input Wi-Fi name and password, click "next".  
(Please set a password first if there is no password)

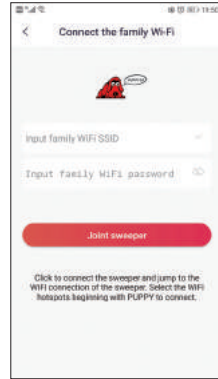

5. Wait for the connection of phone and device.  
(there may be connection failure if many devices under same Wi-Fi or too many phones connect to Wi-Fi, try it several times if failed.)

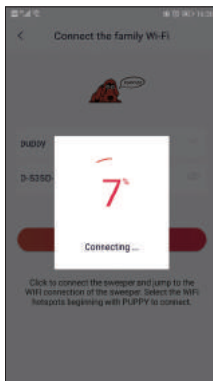

6. Connected successfully, turn to control page.

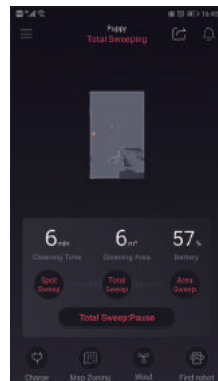

### 3) Operation page

#### Start/pause

- Click "Overall cleaning: start" to clean;
- Click "Overall cleaning: pause" to pause, and save cleaning schedule;
- Click "Overall cleaning: continue" to continue cleaning.

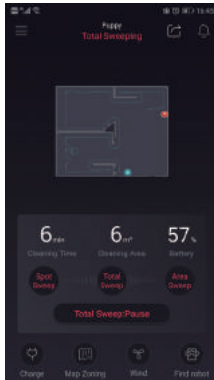

#### Switch cleaning mode

- There are three cleaning modes: "spot cleaning", "overall cleaning" and "area cleaning", and start/pause/continue button, default mode is "overall cleaning".
- For example, click "spot cleaning" while the robot is in "overall cleaning" mode, pop-up window remind "confirm to switch", click confirm, click "spot cleaning: start" to start.
- Switch to "area cleaning" mode in the same way.

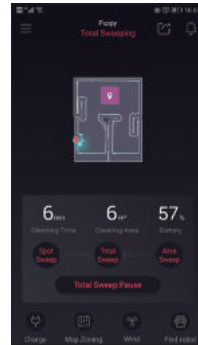

#### Spot cleaning

Click "spot cleaning", there will be a square icon on the map, Long press and drag icon to a certain point, click "spot cleaning: start" robot will move to this point and start cleaning in a area of 1.5\*1.5 meters.  
(Start point is the center of the area)

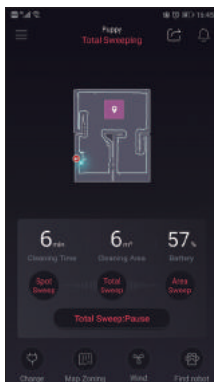

#### Map partition

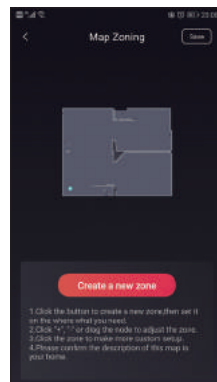

## Area cleaning

1. Set map partition before first use;

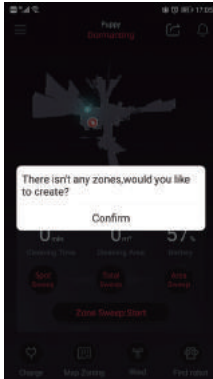

2. Switch to "map partition", click "create new area";

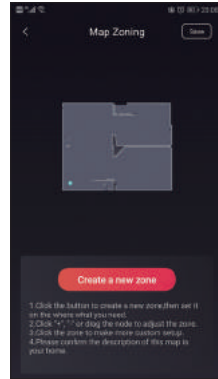

3. Set a label for the area to be created, and there will be a square area to set in the map;

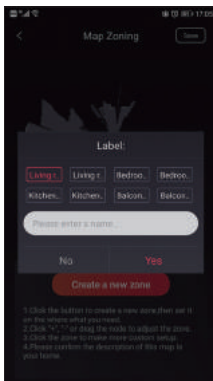

## Area cleaning: normal cleaning

- Click "+" and "-" to add and deduct points, long press and move point to change the shape of cleaning area.
- The area will be defaulted as normal cleaning (marked with pink color), which means the robot will clean this area only. Press "save" to finish setting.

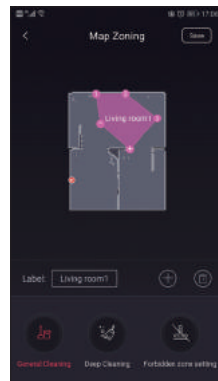

## Area cleaning: deep cleaning

Press “deep cleaning” after map set,(marked with blue color), press “save” to finish setting. This area will be cleaned twice in “area cleaning”.

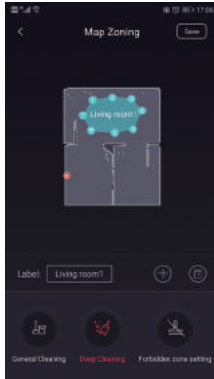

## Area cleaning: forbidden cleaning

Press “forbidden cleaning” after map set,(marked with red color), This area will be forbidden area for the robot, press “save” to finish setting. Note: “forbidden area” will work on all modes, but will be erased if the map is lost or reorganized, and can be deleted in “more- map partition”.

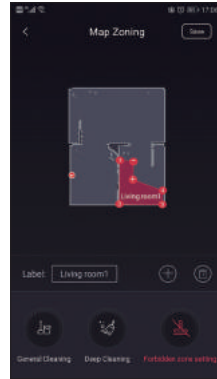

## Area cleaning: area choosing

Press area cleaning after map set, all area set will show up, click an area to clean, there will be a “√” show up on that area, which means only that area will be cleaned.  
Note: Red “forbidden area” will show up on the map all the time.

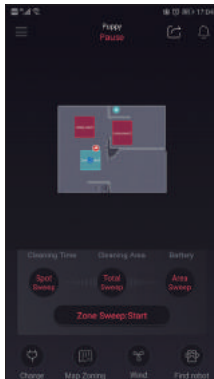

## 4) More function

Click "more" to this page, and choose corresponding function.

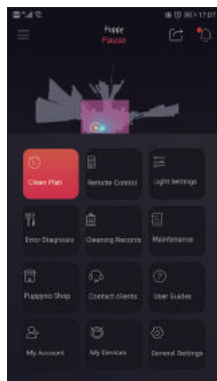

## Appointment cleaning

Click "appointment cleaning" to set cleaning time, mode and frequency, and the robot will start cleaning automatically at appointed time.

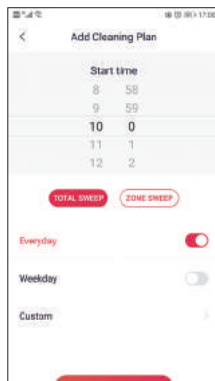

## DND mode

Click "DND" to set DND time, during that period, the robot won't continue cleaning or transmit voice message, but can still be controlled by APP or main body button to start cleaning.

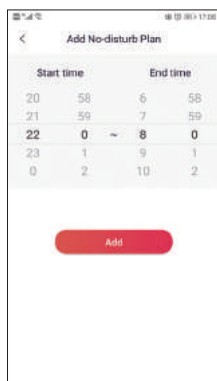

## Delete map

Click "cleaning record" to check cleaning records and "delete map" option. click "delete map" to delete map data, area cleaning and forbidden area data. Put robot vacuum on charging station, and start "delete map" function. Use this function when the map goes wrong.

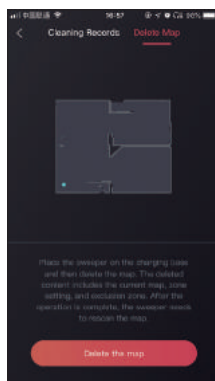

## Remote control

- Choose “remote control” to turn to virtual remote control, long press direction buttons to control moving directions, central button is on/off button.
- The buttons on the bottom are power adjustment, spot cleaning and auto recharge.

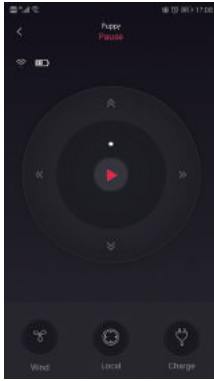

## Light and volume

- Press the central button to turn on/off main body light.
- Set main body broadcast volume by dragging the volume bar.



## Consumable materials record

- Click “consumable materials record” button to check materials using condition, and decide if you need to change consumable materials record. Reset is needed after consumable materials changed.
- Sensors don't have to be replaced, but need to be wiped.



## Diagnose

Click “diagnose” to this interface, and click “start to diagnose” to check, there will be a “√” if there is nothing wrong.

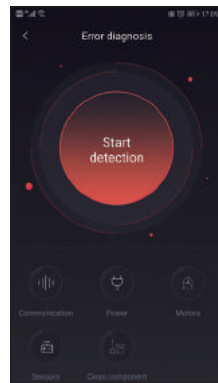

## My device

Click "my device" to the management interface, and manage user list of the device showed on the page.

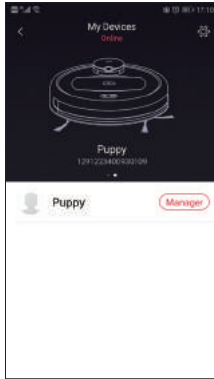

## My device-shared device

Click the small gear button on the right top of "my device" for more control of the device.

- "Add devices" enable a user control many robots.
- "Switch device" enable a user switch control of robots.
- "Share device" enable many users control the robot together.

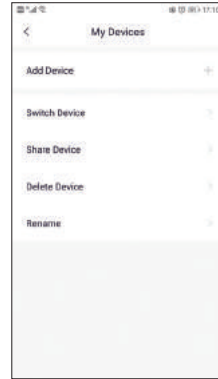

## Product guidance

Click "product guidance" to enter product information interface, learn products according to user's needs.

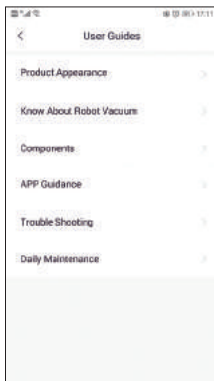

## General setting

Click "general setting" to enter setting interface, update app, software manually, or set APP language.

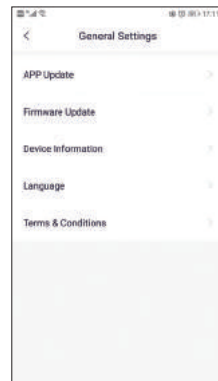

# 5. Product maintenance



## Warm tip:

Please make maintenance for the machine according to your usage frequency

## 5.1 Clean charging contactor

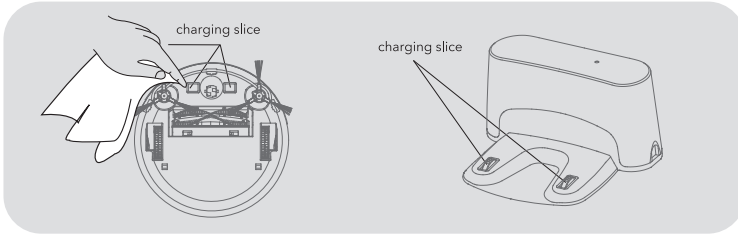

1. Please turn off the power or pull out the plug.
2. Please clean the machine with dry cloth each month.
3. Don't clean it with oils.

## 5.2 Clean dust container

### 5.2.1 Install and uninstall dust container

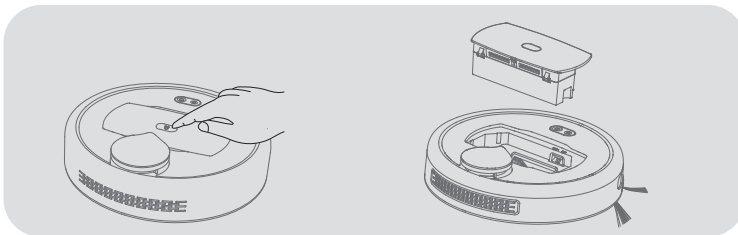

### 5.2.2 Clean dust container

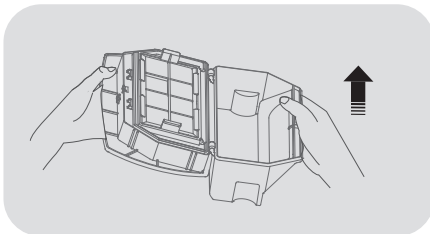

1. Open dust container, pour the dust.

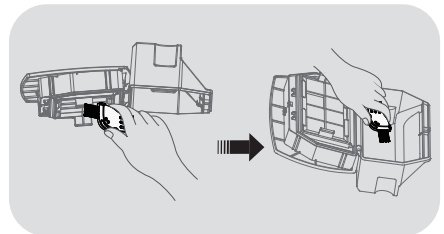

2. Clean dust container with a cleaning brush.

Suggestion: Clean the container every 3 days during the first month, and clean every week afterwards.

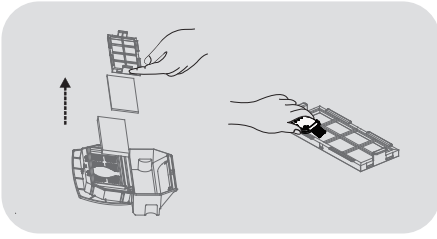

3. Take out filter components, clean dust on the filter with cleaning brush.

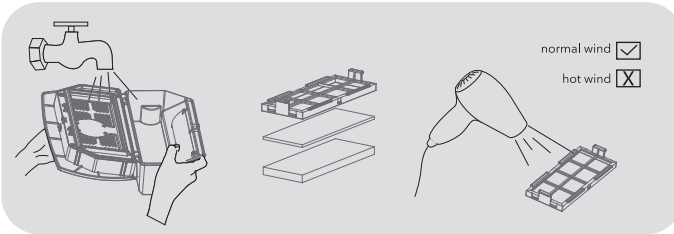

4. Wash dust container and filter net. (Note: dust container can not be reinstall into main body until it is totally dry.)

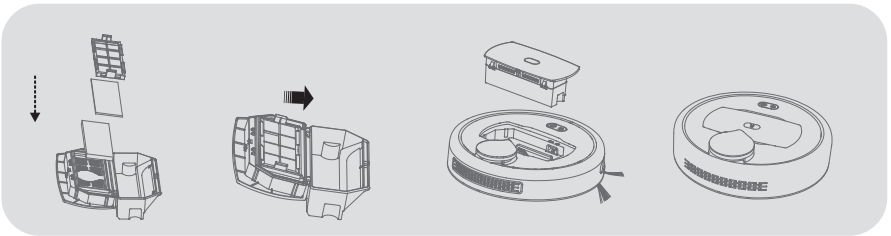

5. Put filter net into dust container after cleaning, and put dust container into the robot.

## 5.3 Clean main brush

### 5.3.1 Install and uninstall dust container

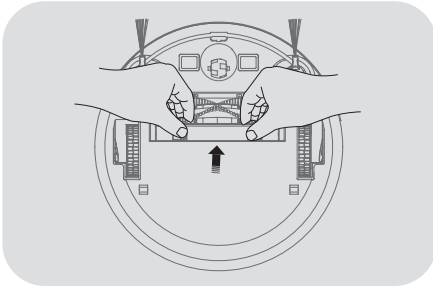

1. Push lock bar and pull up;

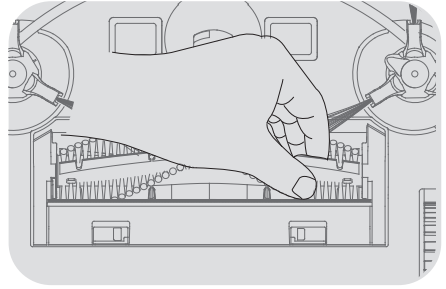

2. Grab the main brush and pull up;

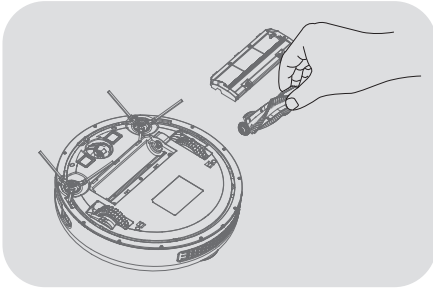

3. Take out rubber bar and main brush.

### 5.3.2 Clean main brush

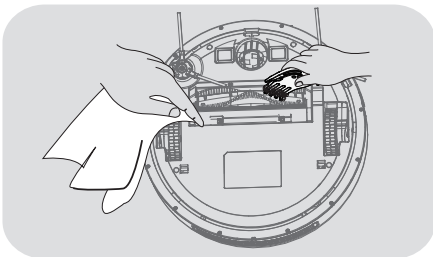

1. As showed in the picture, clean main brush and rubber bar regularly.

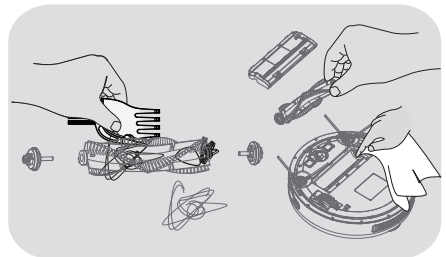

2. As showed in the picture above, clean hair and other particals twined on the main brush.

## 5.4 Clean side brush

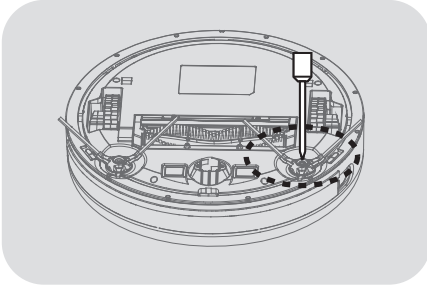

1. Screw out the screws in the side brushes.

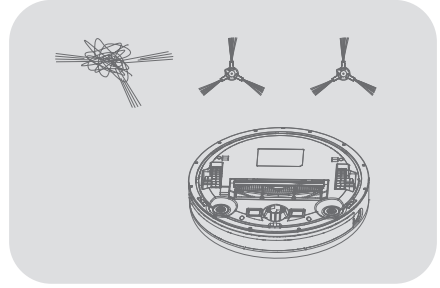

2. Take out the side brushes and clean the hair or other dust on the side brush. Then clean the litters and other twist things inside the neck.

## 5.5 Clean wheels

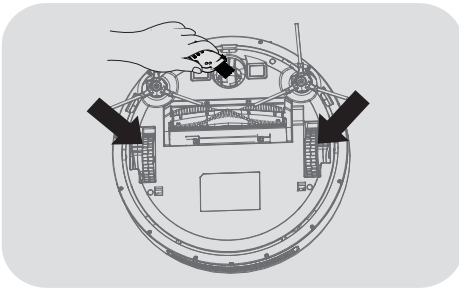

Clean the wheels in front and on both sides of the machine with the cleaning brush regularly.  
(Note: There might be hair, cloth or other things twist on the wheels, please clean them in time)

## 5.6 Clean the Infrared Distance Sensors

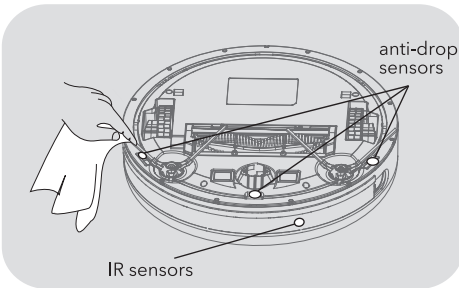

It is suggested to clean the sensors with dry cloth carefully after each time cleaning. It will avoid the dust store on sensors to affect the performance of the machine.

# 6. Trouble shooting

## Trouble indicator:

Red indicator flash on high frequency, please follow voice reminder and check problems

Trouble	Reason	Solution
Dust container problem	Dust container taken out	Set dust container into main body
Dust container is full	Dust container is full or filter net need to be replaced	Clear dust container or replace filter net
Radar problem	Radar is covered or placed on a open area (6*6 meters) with no obstacles	Check if radar is covered or placed outside
Off-ground problem	Robot is lifted up or halt	Put robot back to ground
Ground-examine problem	Anti-drop sensors blocked or placed on a high place	Check if sensors are blocked, do not place it on a high place
Wall-examine problem	PSD along wall sensors problem	Check if transparent window is blocked or not clear
Anti-collision problem	Collision bar or anti-collision sensors get stuck	Check if collision bar or anti-collision sensors are blocked or disturbed
Main wheel problem	Main wheel is stuck or twined	Check if there are entanglements
Side brush problem	Side brush is stuck or twined	Check if there are entanglements
Roller brush problem	Roller brush is stuck or twined	Check if there are entanglements
Stuck problem	Main body is stuck	Check if Main body stuck
Slope problem	Robot starts on a slope	Put robot back to flat ground
Charge station problem	Charge station is missing or power off	Keep main body and charge station in a small distance, connect charge station to the adapter
Unknown problem	Unknown problem	Restart device and try again
Low power	Low power	Charge the robot
Fan problem	Fan stop working	Check if it is loose or twined



### Warm tip:

If you can not rectify the problem by referring to the above methods, please contact customer service.

# 7. Parameters

Main body	
Operating Voltage	DC14.8V
Rated Power	40W
Battery	Li-ion battery
Battery Capacity	6400mAh
Charging Time	4-5 hours
Working Time	240 mins
Working Temperature	5°C-45°C
Charging Temperature	4°C-40°C
Storage Temperature	0°C-45°C
Working Humidity	≤80%RH
Noise	≤65dB
N.W.	3.5KG
Product Size	φ340*105mm

accessories	
Adapter	
Output Voltage	DC24V
Charging Station	
Charging Station Model	CD018
Input Voltage	24V



### Warm tip:

All rights reserved by puppy including modification of technic and design, and right of interpretation

"≡" DIRECT CURRENT SYMBOL

"⏻" STANDBY SYMBOL